

16 APR 2000

RECEIVED

Orchids
on dbase

SOME INDIGENOUS VASCULAR PLANTS IN TWO CONTIGUOUS BLOCKS, SECTION 23 AND SECTION 26, OWNED BY ANDREW WALKER, ON NORTH SIDE OF S.H. 2, IN THE CATCHMENT OF RIMUTAKA STREAM, UPPER HUTT CITY, COMPILED BY B. MITCALFE, J.C. HORNE AND C. PETERSON ON 5 APRIL 1998, NEAR NORTHWESTERN BOUNDARY OF SECTION 23; REVISED BY J. DORING, D. GAWITH, S. STAPLETON, J.C. HORNE AND B.J. MITCALFE ON 20-12-98. ITINERARY, 5 APRIL: FROM BUSH EDGE ON T.L. OF GULLY CONTAINING TRANSIT NZ'S SPOIL DUMP AT "JIM'S CORNER", TO POINT IN RIMUTAKA STREAM JUST ABOVE FORKS WITH STREAM RISING ON TURNBULL, THENCE ACROSS LOW SPUR TO CROSS THAT STREAM; UP THROUGH FOREST TO SCRUB MARGIN AT APPROX. NZMS 260 R27, R28 & Pt. Q27 G.K. 965085; DESCENDED TO THE ABOVE STREAM, CROSSING 100-200m FURTHER UPSTREAM IN EACH CASE; THEN DOWN RIMUTAKA STREAM AND UP SPUR CREST TO SH2 AT CORNER NORTHEAST OF "JIM'S CORNER"; TIME TAKEN APPROXIMATELY 3.5 HOURS; ITINERARY ON 20-12: FROM GATE ON S.H. 2 AT G.R. 956087, TO VALLEY BOTTOM, THEN UP RIMUTAKA STREAM TO G.R. 971079, CLIMBING TO S.H. 2 AT G.R. 972077; TIME TAKEN, 11AM - 5.15PM.

BOTANICAL NAME	MAORI NAME	COMMON NAME
GYMNOSPERM TREES		
<i>Podocarpus hallii</i>	tootara	totara
<i>Prumnopitys ferruginea</i>	miro	miro
MONOCOT TREES		
<i>Cordyline banksii</i>	tii ngahere	forest cabbage tree
DICOT TREES		
<i>Alseuosmia pusilla</i>	toropapa	
<i>Aristolotelia serrata</i>	makomako	wineberry
<i>Brachyglottis repanda</i>	rangiора	rangiора
<i>Carpodetus serratus</i>	putaputaweetaa	marbleleaf
<i>Coprosma foetidissima</i>	huapiro	stinkwood
<i>Coprosma grandifolia</i>	kanono	kanono
<i>Coprosma linariifolia</i>		
<i>Coprosma lucida</i>	karamuu	karamu
<i>Coprosma propinqua</i>		
<i>Coprosma rhamnoides</i>		
<i>Coprosma robusta</i>	karamuu	karamu
<i>Coprosma rotundifolia</i>		
<i>Coprosma rubra</i>		
<i>Coprosma tenuicaulis</i>		
<i>Coprosma propinqua</i> x <i>C. robusta</i>		
<i>Coriaria arborea</i>	tutu	tutu
<i>Cyathodes juniperina</i>	mingimingi	little mingimingi
<i>Elaeocarpus dentatus</i>	hiinau	hiinau
<i>Fuchsia excorticata</i>	kootukutuku	tree fuchsia
<i>Gaultheria rupestre</i>	koropuka	snowberry
<i>Geniostoma rupestre</i> var. <i>ligustrifolium</i>	hangehange	hangehange
<i>Griselinia littoralis</i>	kaapuka	broadleaf
<i>Hebe stricta</i> var. <i>atkinsonii</i>	koromiko	koromiko
<i>Hedycarya arborea</i>	porokaiwhiri	pigeonwood
<i>Helichrysum aggregatum</i>	niniau	

RF&BPROP cont'd, Page 3.

Ctenopteris heterophylla		
Cyathea dealbata	ponga	silver fern
Cyathea medullaris	mamaku	mamaku
Cyathea smithii	kaatote	soft tree fern
Dicksonia fibrosa	whekii ponga	
Dicksonia squarrosa	whekii	wheki
Grammitis billardierei		
Histiopteris incisa	maataa	water fern
Hymenophyllum demissum	mauku	filmy fern
Hymenophyllum dilatatum	"	"
Hymenophyllum flabellatum	"	"
Hymenophyllum multifidum	"	"
Hymenophyllum rarum	"	"
Hymenophyllum revolutum	"	"
Hymenophyllum sanguinolentum	"	"
Hymenophyllum scabrum	"	"
Lastreopsis hispida		
Leptopteris hymenophylloides	heruheru	single crepe fern
Lindsaea trichomanoides		
Paesia scaberula	maataataa	ring fern
Phymatosorus pustulatus	koowaowao	hound's tongue
Pneumatopteris pennigera	paakau	gully fern
Polystichum richardii	pikopiko	shield fern
Polystichum vestitum	puuniu	prickly shield fern
Pteridium esculentum	raarahu	bracken
Pyrrosia eleagnifolia	ota	leatherleaf fern
Rumohra adiantiformis	karawhiu	
Sticherus cunninghamii	tapuaekotuku	umbrella fern
Trichomanes reniforme	raurenga	kidney fern
Trichomanes venosum		

ORCHIDS

Earina autumnalis	raupeka	easter orchid
Earina mucronata	peka a waka	
Winika cunninghamii	winika	

GRASSES

Cortaderia fulvida	toetoe	toetoe
Microlaena avenacea		bush rice grass
Poa anceps		

SEDGES

Carex geminata		
Carex sp.		
Gahnia pauciflora		
Gahnia xanthocarpa	tupari-maunga	
Uncinia banksii		
Uncinia uncinata	matau-a-Maui	hooked sedge

MONOCOT HERBS

Astelia fragrans	kakaha	
Astelia solandri	koowharawhara	
Libertia grandiflora	miikoikoi	NZ iris
Libertia ixioides	miikoikoi	NZ iris

RF&BPROP cont'd, Page 2

Hoheria sexstylosa	houhere	lacebark
Knightia excelsa	rewarewa	rewarewa
Leptospermum scoparium	maanuka	manuka
Leucopogon fasciculatus	mingimingi	big mingimingi
Macropiper excelsum	kawakawa	kawakawa
Melicytus ramiflorus	maahoe	whiteywood
Myrsine australis	maapou	mapou
Myrsine salicina	toro	toro
Nothofagus fusca	tawhai raunui	red beech
Nothofagus menziesii	tawhai	silver beech
Olearia arborescens		
Olearia rani	heketara	heketara
Pennantia corymbosa	kaikoomako	kaikomako
Pittosporum eugenioides	tarata	lemonwood
Pittosporum tenuifolium	kohuhu	kohuhu
Pseudopanax arboreus	whauwhaupaku	fivefinger
Pseudopanax crassifolius	horoeka	lancewood
Pseudowintera axillaris	horopito	
Pseudowintera colorata	horopito	
Raukawa (= Pseudopanax)		
anomalous		
Schefflera digitata	patee	pate
Weinmannia racemosa	kaamahi	kamahi

MONOCOT LIANES

Ripogonum scandens	kareao	supplejack
--------------------	--------	------------

DICOT LIANES

Clematis forsteri	akakaikuu	clematis
Clematis paniculata	puawaananga	clematis
Metrosideros diffusa	raataa	white climbing rata
Metrosideros fulgens	akakura	autumn-flowering rata
Metrosideros perforata	akatea	clinging rata
Parsonsia heterophylla	kaiwhiria	
Rubus cissoides	taataraamo	bush lawyer

LYCOPODS

Lycopodium varium	whiri o Ruakautauri	
Lycopodium volubile	waewaekoukou	climbing club moss
Tmesipteris elongata		
Tmesipteris tannensis		

FERNS

Asplenium bulbiferum	manamana	hen & chickens
Asplenium flaccidum	makawe-o-Raukatauri	hanging spleenwort
Asplenium hookerianum		
Asplenium oblongifolium	huruhuruwhenua	shining spleenwort
Asplenium polyodon	petako	sickle spleenwort
Blechnum chambersii	nini	
Blechnum colensoi	peretao	waterfall fern
Blechnum discolor	piupiu	crown fern
Blechnum fluviatile	kiwakiwa	
Blechnum membranaceum		
Blechnum procerum		
Blechnum novae-zelandiae	kiokio	kiokio

OWNERSHIP

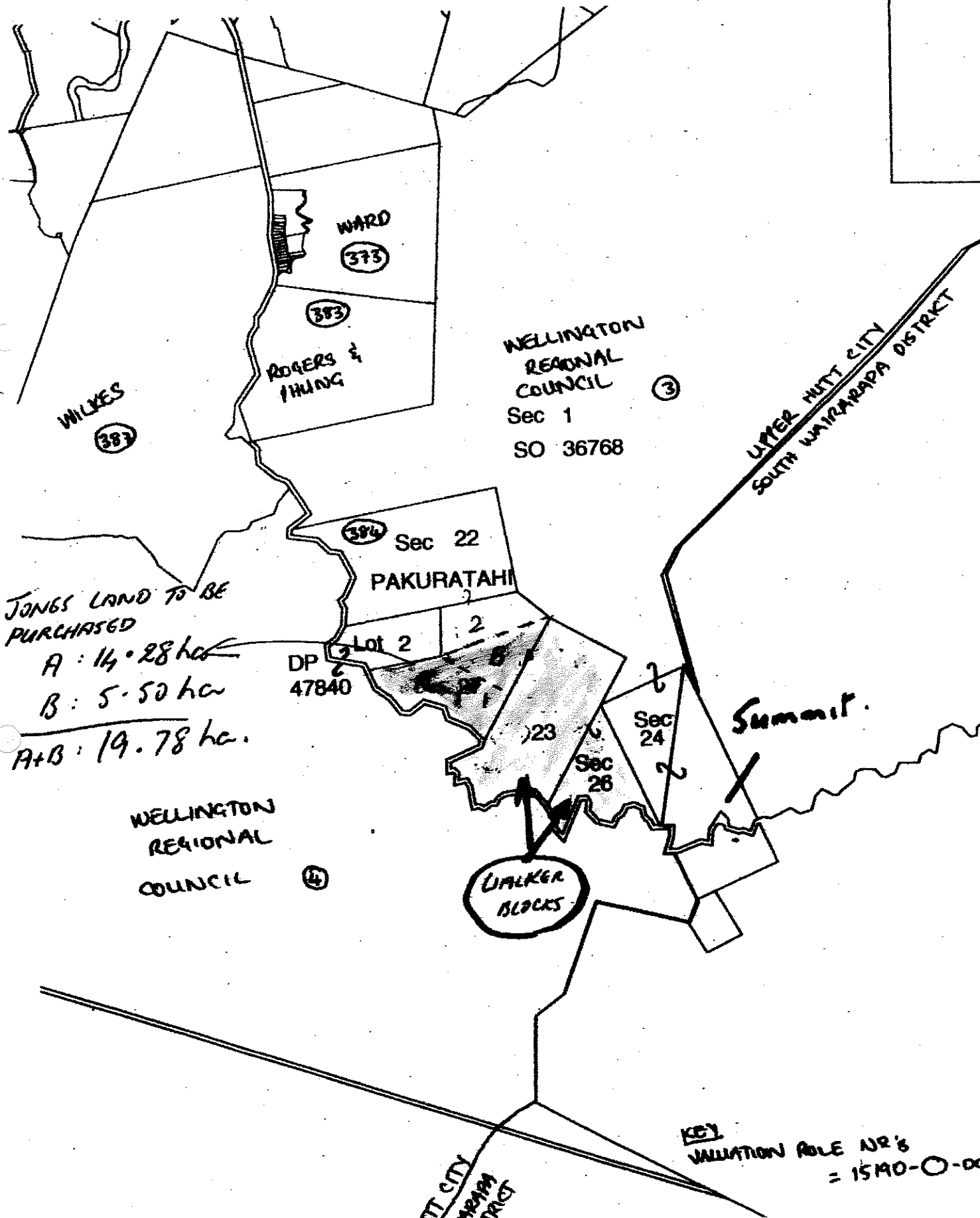

WILKES
383

WARD
373

383
ROGERS &
HUNG

WELLINGTON
REGIONAL
COUNCIL
Sec 1
SO 36768

3

UPPER HUTT CITY
SOUTH WAIRARAPA DISTRICT

394 Sec 22

PAKURATAHI

JONES LAND TO BE
PURCHASED

A: 14.28 ha

B: 5.50 ha

A+B: 19.78 ha.

DP
47840

Lot 2

2

23

Sec 26

Sec 24

Summit.

WELLINGTON
REGIONAL
COUNCIL

4

WALKER
BLOCKS

KEY
VALUATION ROLE NR'S
= 15140-0-00

UPPER HUTT CITY
SOUTH WAIRARAPA DISTRICT